

**SITE ADDRESS: CALOUNDRA SUNSHINE COAST – QUEENSLAND, AUSTRALIA**

**DESCRIPTION:** Sandbar Café & Restaurant – demolish existing, design and and re-fit entire premises

- Preparation of drawings for client discussions.
- Preliminary design of floor plans, kitchen layout.
- Prepare drawings for building approval application.
- Prepare drawings for Food licence and Council health department applications.
- Create finishes schedule and materials samples with colour boards for client.
- Co-ordinate hydraulics engineer's design and documentation for ultimate procurement of plumbing and drainage approvals.
- Co-ordinate structural engineers for shop-front facade and bulkheads replacement.
- Prepare and negotiate building consent application and procure building approvals.
- Prepare and negotiate plumbing & drainage consent application and procure approvals.
- Prepare and negotiate applications for Food licence and Health department approvals.
- Coordinate responses to Council requests for further information pertaining to all above consent applications.
  - Formulate MS Project construction programmes and circulate for comment.
  - Co-ordinate consultants and trade works quotes and prepare preliminary cost estimates.
  - Prepare tender packages.
  - Co-ordinate tender process.
  - Complete final contract documentation – client & trades.
  - Finalise construction schedule.
  - Project manage demolition works and fit-out works.
  - Site manage all works.
  - Manage cash-flow and invoicing.
  - Organise and attend inspections.
  - Complete documentation for authorities' sign-off.
  - Oversee invoicing and ensure payments are made in accordance with contract milestones.



**SITE ADDRESS: MOFFAT BEACH SUNSHINE COAST – QUEENSLAND, AUSTRALIA**

**DESCRIPTION:** Pocket Espresso Coffee Bar – design and complete fit-out of existing premises / previously an Australia Post outlet.

- Preparation of sketch drawings for client discussions.
- Preliminary design of floor plans, bar and kitchen layout.
- Prepare drawings for building approval application.
- Prepare drawings for Food licence council applications.
- Co-ordinate hydraulics engineer's design and documentation for ultimate procurement of plumbing and drainage approvals.
- Prepare and negotiate building consent application and procure building approvals.
- Prepare and negotiate plumbing & drainage consent application and procure approvals.
- Prepare and negotiate applications for Food licence and Health department approvals.
- Coordinate responses to Council requests for further information pertaining to all above consent applications.
- Formulate MS Project construction programmes and circulate for comment.
- Co-ordinate consultants and trade works quotes and prepare preliminary cost estimates.
- Prepare tender packages.
- Co-ordinate tender process.
- Complete final contract documentation – client & trades.
- Finalise construction schedule.
- Project manage fit-out works.
- Site manage all works.
- Manage cash-flow and invoicing.
- Organise and attend inspections.



**SITE ADDRESS: GYMPIE – QUEENSLAND, AUSTRALIA**

**DESCRIPTION:** Mitre 10 Café – design and construct cafe including internal structure and services in new Mitre 10 store.



- Preparation of sketch and CAD drawings for client discussions.
- Preliminary design of floor plans, kitchen layout.
- Prepare drawings for building approval application.
- Prepare drawings for Food licence and Council health department applications.
- Co-ordinate hydraulics engineer's design and documentation for ultimate procurement of plumbing and drainage approvals.
- Co-ordinate structural engineers for internal roof structure.
- Prepare and negotiate building consent application and procure building approvals.
- Prepare and negotiate plumbing & drainage consent application and procure approvals.
- Prepare and negotiate applications for Food licence and Health department approvals.
- Coordinate responses to Council requests for further information pertaining to all above consent applications.
- Formulate MS Project construction programmes and circulate for comment.
- Co-ordinate consultants and trade works quotes and prepare preliminary cost estimates.
- Prepare tender packages.
- Co-ordinate tender process.
- Complete final contract documentation – client & trades.
- Finalise construction schedule.
- Site manage all works.
- Manage cash-flow and invoicing.
- Organise and attend inspections.
- Complete documentation for authorities' sign-off.
- Oversee invoicing and ensure payments are made in accordance with contract milestones.

**SITE ADDRESS: RAINBOW BEACH – QUEENSLAND, AUSTRALIA**

**DESCRIPTION:** Rainbow Beach Surf Life Saving Club - complete internal demolition of existing bar and replace with new bar.



- Preparation of sketch and CAD drawings for client discussions.
- Preliminary design of floor plans, bar layout.
- Prepare drawings for Food licence and Council health department applications.
- Create finishes schedule and materials samples with colour boards for client sign-off.
- Prepare and negotiate applications for Food licence and Health department approvals.
- Co-ordinate consultants and trade works quotes and prepare preliminary cost estimates.
- Complete final contract documentation – client & trades.
- Finalise construction schedule.
- Project manage fit-out works.
- Site manage all works.
- Manage cash-flow and invoicing.
- Organise and attend inspections.
- Oversee invoicing and ensure payments are made in accordance with contract milestones.

**SITE ADDRESS: MOOLOOLABA, SUNSHINE COAST – QUEENSLAND, AUSTRALIA**

**DESCRIPTION:** Curry Time Indian Restaurant & Bar – design and complete entire fit-out in vacant tenancy previously used as a dress shop.

- Preparation of drawings for client discussions.
- Preliminary design of floor plans, kitchen layout.
- Prepare drawings for building approval application.
- Prepare drawings for Food licence and council health department applications.
- Co-ordinate hydraulics engineer's design and documentation for ultimate procurement of plumbing and drainage approvals.
- Prepare and negotiate building consent application and procure building approvals.
- Prepare and negotiate plumbing & drainage consent application and procure approvals.
- Prepare and negotiate applications for Food licence and Health department approvals.
- Coordinate responses to Council requests for further information pertaining to all above consent applications.
- Formulate MS Project construction programmes and circulate for comment.
  - Co-ordinate consultants and trade works quotes and prepare preliminary cost estimates.
  - Prepare tender packages.
  - Co-ordinate tender process.
  - Complete final contract documentation – client & trades.
  - Finalise construction schedule.
  - Project manage demolition works and fit-out works.
  - Site manage all works.
  - Manage cash-flow and invoicing.
  - Organise and attend inspections.
  - Complete documentation for authorities' sign-off.
  - Oversee invoicing.



**SITE ADDRESS: COOLUM BEACH, SUNSHINE COAST – QUEENSLAND, AUSTRALIA**

**DESCRIPTION:** Complete design and entire fit-out in vacant tenancy

- Preparation of drawings for client discussions.
- Preliminary design of floor plans, kitchen layout.
- Prepare drawings for building approval application.
- Prepare drawings for Food licence and Council health department applications.
- Co-ordinate hydraulics engineer's design and documentation for ultimate procurement of plumbing and drainage approvals.
- Prepare and negotiate building consent application and procure building approvals.
- Prepare and negotiate plumbing & drainage consent application and procure approvals.
- Prepare and negotiate applications for Food licence and Health department approvals.
- Coordinate responses to Council requests for further information pertaining to all above consent applications.
- Formulate MS Project construction programmes and circulate for comment.
- Co-ordinate consultants and trade works quotes and prepare preliminary cost estimates.
- Prepare tender packages.
- Co-ordinate tender process.
- Complete final contract documentation – client & trades.
- Finalise construction schedule.
- Project manage demolition works and fit-out works.
- Site manage all works.
- Manage cash-flow and invoicing.
- Organise and attend inspections.
- Complete documentation for authorities' sign-off.
- Oversee invoicing and ensure payments are made in accordance with contract milestones.



**SITE ADDRESS: MOOLOOLABA BEACH, SUNSHINE COAST – QUEENSLAND, AUSTRALIA**

**DESCRIPTION:** Hippodrome French Café – demolish, design and re-fit of existing café



- Preparation of sketch and CAD drawings for client discussions.
- Preliminary design of kitchen layout.
- Prepare drawings for Food licence and Council health department applications.
- Complete final contract documentation – client & trades.
- Finalise construction schedule.
- Site manage all works.
- Manage cash-flow and invoicing.
- Complete documentation for authorities' sign-off.
- Oversee invoicing and ensure payments are made in accordance with contract milestones.

**SITE ADDRESS: CALOUNDRA, SUNSHINE COAST – QUEENSLAND, AUSTRALIA**

**DESCRIPTION:** Caloundra Events Centre – demolish, design and re-fit of existing bar

- Preparation of sketch and CAD drawings for client discussions.
- Preliminary design of bar layout and frontage.
- Prepare drawings for Food licence and Council health department applications.



**SITE ADDRESS: GYMPIE, SUNSHINE COAST – QUEENSLAND, AUSTRALIA**

**DESCRIPTION:** Gympie Kebabs – design and complete entire fit-out in new building

- Preparation of drawings for client discussions.
- Preliminary design of floor plans, cafe and kitchen layout.
- Prepare drawings for building approval application.
- Prepare drawings for Food licence and council health department applications.
- Co-ordinate hydraulics engineer's design and documentation for ultimate procurement of plumbing and drainage approvals.
- Prepare and negotiate building consent application and procure building approvals.
- Prepare and negotiate plumbing & drainage consent application and procure approvals.
- Prepare and negotiate applications for Food licence and Health department approvals.
- Coordinate responses to Council requests for further information pertaining to all above consent applications.
  - Formulate MS Project construction programmes and circulate for comment.
  - Co-ordinate consultants and trade works quotes and prepare preliminary cost estimates.
  - Prepare tender packages.
  - Co-ordinate tender process.
  - Complete final contract documentation – client & trades.
  - Finalise construction schedule.
  - Project manage demolition works and fit-out works.
  - Site manage all works.
  - Manage cash-flow and invoicing.
  - Organise and attend inspections.
  - Complete documentation for authorities' sign-off.
  - Oversee invoicing.





**SITE ADDRESS:                SOUTHSIDE, GYMPIE, SUNSHINE COAST – QUEENSLAND, AUSTRALIA**

**DESCRIPTION:                Southside Bakery – design and complete entire fit-out in new building**

- Preparation of drawings for client discussions.
- Preliminary design of floor plans, cafe and kitchen layout.
- Prepare drawings for building approval application.
- Prepare drawings for Food licence and council health department applications.
- Co-ordinate hydraulics engineer's design and documentation for ultimate procurement of plumbing and drainage approvals.
- Prepare and negotiate building consent application and procure building approvals.
- Prepare and negotiate plumbing & drainage consent application and procure approvals.
- Prepare and negotiate applications for Food licence and Health department approvals.
- Coordinate responses to Council requests for further information pertaining to all above consent applications.
- Formulate MS Project construction programmes and circulate for comment.
- Co-ordinate consultants and trade works quotes and prepare preliminary cost estimates.
- Prepare tender packages.
- Co-ordinate tender process.
- Complete final contract documentation – client & trades.
- Finalise construction schedule.
- Project manage demolition works and fit-out works.
- Site manage all works.
- Manage cash-flow and invoicing.
- Organise and attend inspections.
- Complete documentation for authorities' sign-off.
- Oversee invoicing.



**SITE ADDRESS:                WEST END, BRISBANE - AUSTRALIA**

**DESCRIPTION:                Tsuru Sushi Café & Takeaway – design and complete entire fit-out in flood-damaged building**

- Preparation of drawings for client discussions.
- Preliminary design of floor plans, cafe and kitchen layout.
- Prepare drawings for building approval application.
- Prepare drawings for Food licence and council health department applications.
- Co-ordinate hydraulics engineer's design and documentation for ultimate procurement of plumbing and drainage approvals.
- Prepare and negotiate building consent application and procure building approvals.
- Prepare and negotiate plumbing & drainage consent application and procure approvals.
- Prepare and negotiate applications for Food licence and Health department approvals.
- Coordinate responses to Council requests for further information pertaining to all above consent applications.
- Formulate MS Project construction programmes and circulate for comment.
- Co-ordinate consultants and trade works quotes and prepare preliminary cost estimates.
- Prepare tender packages.
- Co-ordinate tender process.
- Complete final contract documentation – client & trades.
- Finalise construction schedule.
- Project manage demolition works and fit-out works.
- Site manage all works.
- Manage cash-flow and invoicing.
- Organise and attend inspections.
- Complete documentation for authorities' sign-off.
- Oversee invoicing.





**SITE ADDRESS:** **PELICAN WATERS, SUNSHINE COAST - QUEENSLAND, AUSTRALIA**

**DESCRIPTION:** Indian Accent Indian Restaurant & Takeaway - design new restaurant & takeaway

- Preparation of for client discussions.
- Preliminary design of bar layout and frontage.
- Prepare drawings for Food licence and Council health department applications
- 

**SITE ADDRESS:** **GYMPIE, SUNSHINE COAST- QUEENSLAND, AUSTRALIA**

**DESCRIPTION:** Gympie Paninis - complete re-fit of existing tenancy

- Complete final contract documentation – client & trades.
- Finalise construction schedule.
- Project manage demolition works and fit-out works.
- Site manage all works.
- Manage cash-flow and invoicing.
- Arrange equipment deliveries
- Oversee invoicing.



**SITE ADDRESS:** **NOOSA HEADS- QUEENSLAND, AUSTRALIA**

**DESCRIPTION:** Absolute World Café – design and complete entire fit-out in vacant tenancy

- Preparation of drawings for client discussions.
- Preliminary design of floor plans, cafe and kitchen layout.
- Prepare drawings for building approval application.
- Prepare drawings for Food licence and council health department applications.
- Co-ordinate hydraulics engineer's design and documentation for ultimate procurement of plumbing and drainage approvals.
- Prepare and negotiate building consent application and procure building approvals.
- Prepare and negotiate plumbing & drainage consent application and procure approvals.
  - Prepare and negotiate applications for Food licence and Health department approvals.
  - Coordinate responses to Council requests for further information pertaining to all above consent applications.
  - Formulate MS Project construction programmes and circulate for comment.
  - Co-ordinate consultants and trade works quotes and prepare preliminary cost estimates.
  - Complete final contract documentation – client & trades.
  - Finalise construction schedule.
  - Project manage fit-out works.
  - Site manage all works.
  - Manage cash-flow and invoicing.
  - Organise and attend inspections.
  - Complete documentation for authorities' sign-off.
  - Oversee invoicing.



SITE ADDRESS:

**MACKAY, CENTRAL QUEENSLAND - AUSTRALIA**



DESCRIPTION:

Sarina Rugby Leagues Club – re-fit of existing commercial kitchen

- Complete final contract documentation – client & trades.
- Finalise construction schedule.
- Project manage fit-out works.
- Site manage all works.
- Manage cash-flow and invoicing.
- Oversee invoicing.

SITE ADDRESS:

**NOOSAVILLE, SUNSHINE COAST – QUEENSLAND, AUSTRALIA**

DESCRIPTION:

Acres Garden Centre – design and complete entire fit-out of juice bar in new building

- Preparation of sketch and CAD drawings for client discussions.
- Preliminary design of floor plans, cafe and kitchen layout.
- Prepare drawings for building approval application.
- Prepare drawings for Food licence and council health department applications.
- Co-ordinate hydraulics engineer's design and documentation for ultimate procurement of plumbing and drainage approvals.
- Prepare and negotiate building consent application and procure building approvals.
- Prepare and negotiate plumbing & drainage consent application and procure approvals.
- Prepare and negotiate applications for Food licence and Health department approvals.
- Coordinate responses to Council requests for further information pertaining to all above consent applications.
- Formulate MS Project construction programmes and circulate for comment.
- Co-ordinate consultants and trade works quotes and prepare preliminary cost estimates.
- Complete final contract documentation – client & trades.
- Finalise construction schedule.
- Project manage fit-out works.
- Manage cash-flow and invoicing.
- Organise and attend inspections.
- Complete documentation for authorities' sign-off.
- Oversee invoicing.



SITE ADDRESS:

**PERTH, WESTERN AUSTRALIA**

DESCRIPTION:

Hillcrest Regis Healthcare - design of new commercial kitchen and satellite kitchens for extension to existing aged care facility



- Preliminary investigation into feasibility with architects and engineers
- Design new commercial kitchen
- Client and operator liaison regards satellite kitchen function and lay-out
- Co-ordinate consultants and trade works quotes and prepare preliminary cost estimates.
- Assist with preparation of tender packages.

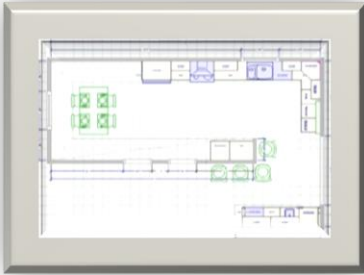

**SITE ADDRESS: GLADSTONE, CENTRAL QUEENSLAND - AUSTRALIA**

**DESCRIPTION:** Toolooa State High School – design of new tuck-shop

- Preparation of sketch and CAD drawings for client discussions.
- Preliminary design of commercial kitchen layout
- Feasibility
- Preliminary costing

**SITE ADDRESS: NOOSAVILLE, SUNSHINE COAST – QUEENSLAND, AUSTRALIA**

**DESCRIPTION:** Blue Ginger Café – design and complete fit-out of café and commercial kitchen in vacant tenancy



- Preparation of drawings for client discussions.
- Preliminary design of floor plans, cafe and kitchen layout.
- Prepare drawings for Food licence and council health department applications.
- Prepare and negotiate building consent application and procure building approvals.
- Prepare and negotiate plumbing & drainage consent application and procure approvals.
- Prepare and negotiate applications for Food licence and Health department approvals.
- Coordinate responses to Council requests for further information pertaining to all above consent applications.
- Formulate MS Project construction programmes and circulate for comment.
- Complete final contract documentation – client & trades.
- Finalise construction schedule.
- Co-ordinate consultants and trade works quotes and prepare

- preliminary cost estimates.
- Project manage fit-out works.
- Manage cash-flow and invoicing.
- Organise and attend inspections.
- Complete documentation for authorities' sign-off.
- Oversee invoicing.

**SITE ADDRESS: NOOSA MARINA, SUNSHINE COAST – QUEENSLAND, AUSTRALIA**

**DESCRIPTION:** Noosa Marina Italian Restaurant – design new restaurant and complete partial fit-out

- Preparation of sketch and CAD drawings for client discussions.
- Preliminary design of bar layout and frontage.
- Prepare drawings for Food licence and Council health department applications.

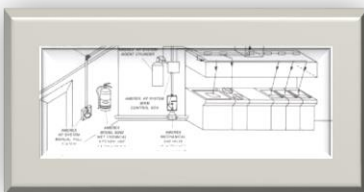

**SITE ADDRESS: PERTH, WESTERN AUSTRALIA**

**DESCRIPTION:** Hollywood Regis Healthcare - design of new commercial kitchen and satellite kitchens for new 300 bed facility

- Preliminary investigation into feasibility with architects and engineers
- Design of new commercial kitchen
- Co-ordinate consultants and trade works quotes, preliminary estimates.



**SITE ADDRESS: PORT OF BRISBANE – QUEENSLAND, AUSTRALIA**

**DESCRIPTION:** Attenborough Catering – design and construct mobile kitchen and servery area to construction site at Brisbane Port

- Preparation of sketch and CAD drawings for client discussions.
- Preliminary design of floor plans, servery area and kitchen layout.
- Prepare drawings for building approval application.
- Prepare drawings for Food licence and council health department applications.
- Prepare and negotiate building consent application and procure building approvals.
  - Prepare and negotiate applications for Food licence and Health department approvals.
  - Coordinate responses to Council requests for further information pertaining to all above consent applications.
  - Formulate MS Project construction programmes and circulate for comment.
  - Co-ordinate consultants and trade works quotes and prepare preliminary cost estimates.
  - Complete final contract documentation – client & trades.
  - Finalise construction schedule.
  - Project manage fit-out works.
  - Manage cash-flow and invoicing.
  - Organise and attend inspections.
  - Complete documentation for authorities' sign-off.
  - Oversee invoicing.



**SITE ADDRESS: KAWANA, SUNSHINE COAST – QUEENSLAND, AUSTRALIA**

**DESCRIPTION:** Club Kawana Bowls Club - design of commercial kitchen alterations

- Preliminary investigation into feasibility with architects
- Design of commercial kitchen alteration
- Co-ordinate consultants and trade works quotes and prepare preliminary cost estimates.



**SITE ADDRESS: JONDARYAN, TOOWOOMBA – QUEENSLAND, AUSTRALIA**

**DESCRIPTION:** Jondaryan Woolshed - design and construct mobile kitchen and scullery area to existing tourism facility

- Preparation of drawings for client discussions.
- Preliminary design of floor plans, servery area and kitchen layout of containerised kitchens
- Prepare drawings for building approval application.
- Prepare drawings for Food licence and council health department applications.
- Prepare and negotiate building consent application and procure building approvals.
- Prepare and negotiate applications for Food licence and Health department approvals.
  - Coordinate responses to Council requests for further information pertaining to all above consent applications.
  - Formulate MS Project construction programmes and circulate for comment.
  - Co-ordinate consultants and trade works quotes and prepare preliminary cost estimates.
  - Complete final contract documentation – client & trades.
  - Finalise construction schedule.
  - Project manage fit-out works.
  - Site manage all works.
  - Manage cash-flow and invoicing.
  - Organise and attend inspections.
  - Complete documentation for authorities' sign-off.
  - Contract management.

