

SITE ADDRESS: **84 RAME ROAD, GREENHITHE, AUCKLAND**

DESCRIPTION: Stage 1. Resource consent / renewal of Marine Pile leasing arrangements
Stage 2. Re-development of site. Change of use from Boatbuilders (Salhouse Boatbuilders) to Apartments and ancillary Boat sheds.

Stage 1:

- Site measure existing wharves and buildings

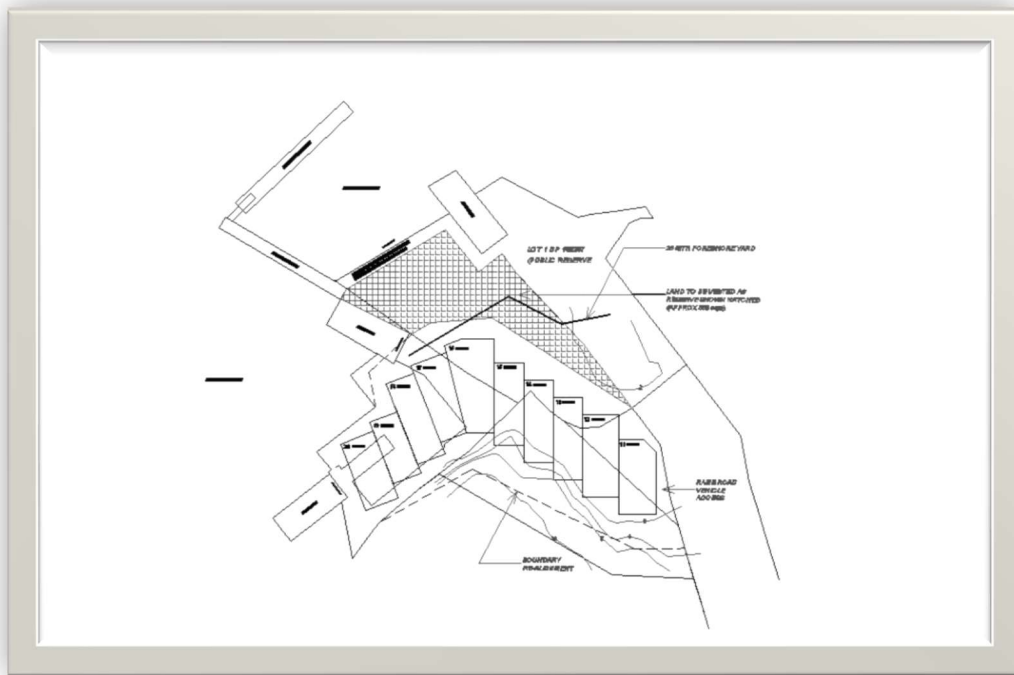

Stage 2

- Complete concept design of apartments and ancillary boat sheds

84 RAME ROAD REFEREES:

- Greg Salhouse Salhouse Boatbuilders
021 412 432 greg@salhouseboats.com
- Delayne Salhouse Salhouse Boatbuilders
021 313 707 delayne@salhouseboats.com
- John Lovett Lovett Planning
021 344 376 lovettpanning@gmail.com

